

MCLAIN HILLS SUBDIVISION

HOMER TOWNSHIP FRACTION 23 R13 TWP 7 MORGAN COUNTY, OH

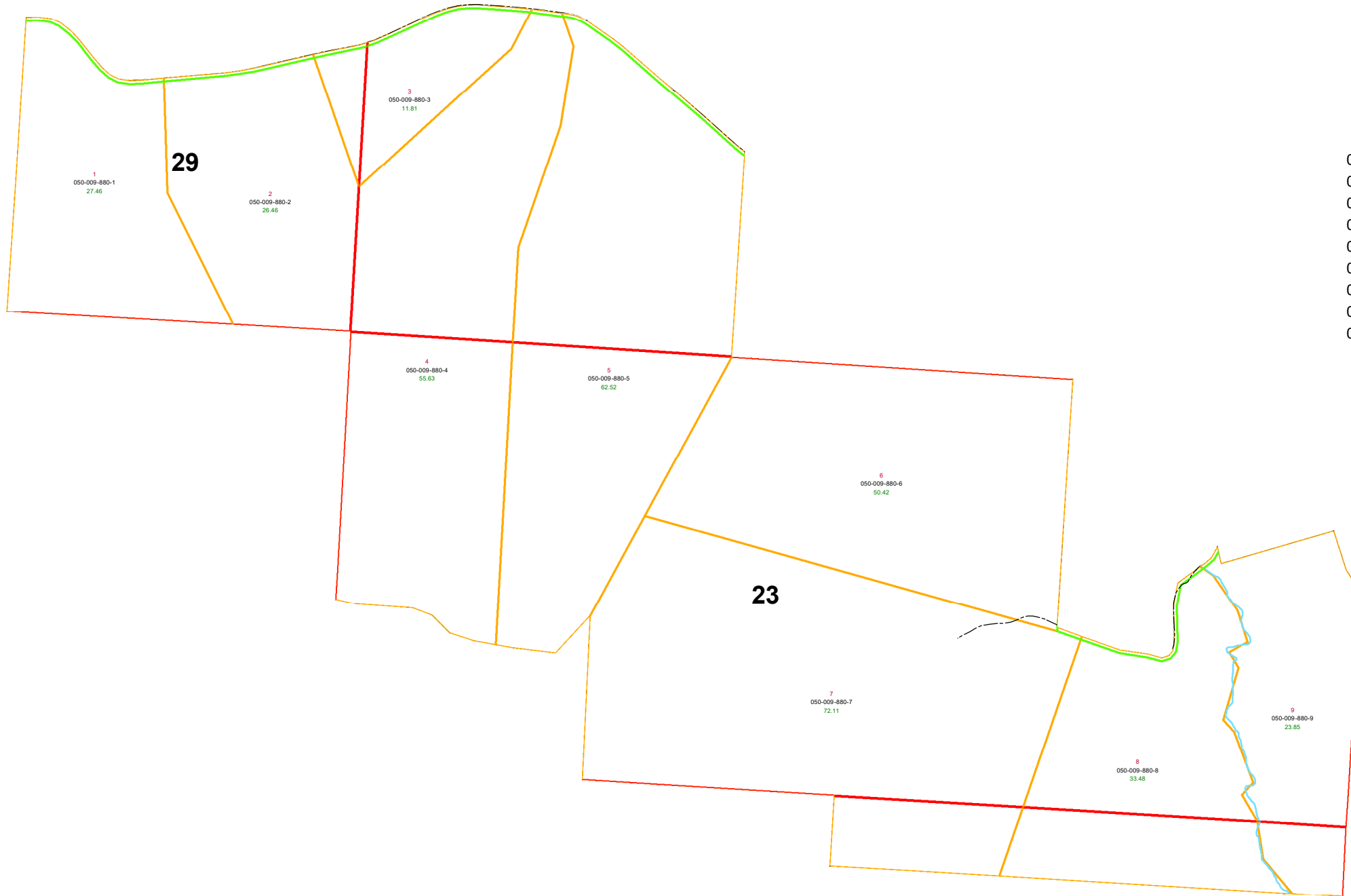

PIN	VOL	PAG	Owner	LegalDescr	Acre
050-009-880-9	OR183	745	DOLAN GARY D & LESLIE A	R13 T07 S29 LOT 9 MCLAIN HILLS	23.85
050-009-880-1	OR130	16	DZIEWATKOSKI NICHOLAS	R13 T7 S29 LOT 1 MCLAIN HILLS S	27.46
050-009-880-3	OR194	341	MONTGOMERY SHANE C & KATHLEEN J	R13 T07 S29 LOT 3 MCLAIN HILLS	11.81
050-009-880-5	OR136	502	SMITH KENNARD M & CARMELITA B	R13 T07 S29 LOT 5 MCLAIN HILLS	62.52
050-009-880-4	OR136	502	SMITH KENNARD M & CARMELITA B	R13 T07 S29 LOT 4 MCLAIN HILLS	55.63
050-009-880-8	OR220	3220	SMITH SHERMAN A & PAMELA C	R13 T07 S29 LOT 8 MCLAIN HILLS	33.48
050-009-880-7	OR220	3220	SMITH SHERMAN A & PAMELA C	R13 T07 S29 LOT 7 MCLAIN HILLS	72.11
050-009-880-6	OR220	3220	SMITH SHERMAN A & PAMELA C	R13 T07 S29 LOT 6 MCLAIN HILLS	50.42
050-009-880-2	OR217	3202	VEGH SANDOR & TRACIE L	R13 T07 S29 LOT 2 MCLAIN HILLS	26.46

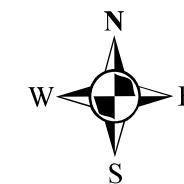

Boundaries	
-----	Hidden
-----	Roads
-----	County
-----	Lot
-----	Parcel
-----	Section
-----	Township
-----	Parcels
-----	ROW

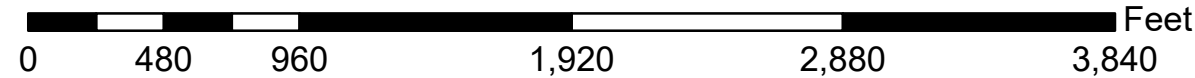

Disclaimer: The information that these maps contains is for reference purposes only. Please bring any errors to the attention of the Engineer's Office staff.
Thank you